

Nickel-Plated Brass DOT Fittings NPTF/Inch Series ND ND6580 Union

Tube Diameter OD : 5/32", 1/4", 3/8", 1/2", 5/8", 3/4"

Thread Type : 1/8", 1/4", 3/8", 1/2", 3/4" NPTF

PUSH-IN FITTINGS

DIMENSIONS (in inches)					
Part No.	A OD	C	F	G	L
ND6580 53-00	5/32	0.520	0.331	0.354	1.142
ND6580 04-00	1/4	0.606	0.461	0.472	1.319
ND6580 06-00	3/8	0.787	0.606	0.650	1.673
ND6580 08-00	1/2	0.787	0.736	0.768	1.673
ND6580 10-00	5/8	0.976	0.925	0.976	2.047
ND6580 12-00	3/4	1.094	1.055	1.094	2.047

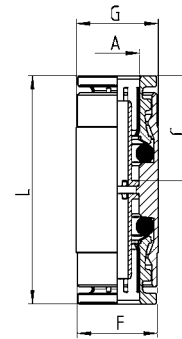

The US Department prohibits the use of air brake tubing assemblies between the frame and axle or between a towed and towing vehicle.

- Meets all requirements for Federal DOT Standard 571.106* 49 CFR Ch. V
- Meets all requirements for SAE J2494-3
- Temperature Range: -58°F to 200°F
- Electrolytic Nickel Plated brass body with a low temperature BUNA-N O-ring
- For use with SAE J844 A & B Nylon tubing
- Compressed air applications

GENERAL DATA

Material	Electrolytic Nickel-plated brass OT58 UNI 5705, Tube-support/insert in glass-reinforced Nylon
Collet	Brass OT58, nickel plated
O-ring	Low temperature Buna-N (NBR)
Threads	10/32 UNF, 1/8", 1/4", 3/8", 1/2", 3/4" NPTF
Temperature Range	-58°F - 200°F
Operating pressure	0 - 275 psi (3/4" tube size operating pressure = 0 - 175 psi)
Fluid	Compressed air [for other types of fluid please contact your local Camozzi branch]
Tube diameter	5/32", 1/4", 3/8", 1/2", 5/8", 3/4" OD