

Nickel-Plated Brass DOT Fittings NPTF/Inch Series ND ND6500 Male Non-Swivel Elbow

Tube Diameter OD : 5/32", 1/4", 3/8", 1/2", 5/8", 3/4"

Thread Type : 1/8", 1/4", 3/8", 1/2", 3/4" NPTF

PUSH-IN FITTINGS

DIMENSIONS (in inches)								
Model	A OD	D NPTF	C	F	E	H	M	SW
ND6500 04-02	1/4	1/8	0.606	0.500	0.472	0.354	0.807	0.354
ND6500 04-04	1/4	1/4	0.606	0.500	0.472	0.472	0.807	0.354
ND6500 04-06	1/4	3/8	0.606	0.500	0.531	0.512	0.906	0.472
ND6500 04-08 *	1/4	1/2	0.606	0.500	0.728	0.630	0.807	0.591
ND6500 06-02	3/8	1/8	0.787	0.650	0.531	0.335	1.043	0.512
ND6500 06-04	3/8	1/4	0.787	0.650	0.551	0.492	1.043	0.512
ND6500 06-06	3/8	3/8	0.787	0.650	0.512	0.472	1.043	0.512
ND6500 06-08	3/8	1/2	0.787	0.650	0.728	0.630	1.063	0.591
ND6500 08-04	1/2	1/4	0.787	0.768	0.610	0.492	1.102	0.591
ND6500 08-06	1/2	3/8	0.787	0.768	0.571	0.492	1.102	0.591
ND6500 08-08	1/2	1/2	0.787	0.768	0.728	0.630	1.102	0.591
ND6500 08-12 *	1/2	3/4	0.787	0.768	0.827	0.630	1.102	0.945
ND6500 10-06	5/8	3/8	0.976	0.984	0.689	0.492	1.378	0.787
ND6500 10-08	5/8	1/2	0.976	0.984	0.748	0.610	1.378	0.787
ND6500 12-06 *	3/4	3/8	1.094	1.122	0.768	0.492	1.437	0.945
ND6500 12-08	3/4	1/2	1.094	1.122	0.827	0.630	1.437	0.945
ND6500 12-12	3/4	3/4	1.094	1.122	0.827	0.630	1.437	0.945

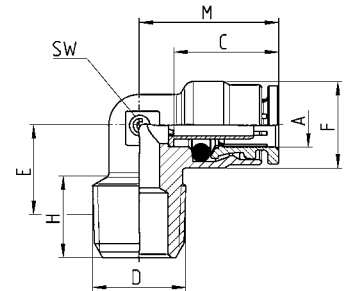

*Produced Upon Request
Contact Camozzi USA for Availability

The US Department prohibits the use of air brake tubing assemblies between the frame and axle or between a towed and towing vehicle.

- Meets all requirements for Federal DOT Standard 571.106* 49 CFR Ch. V
- Meets all requirements for SAE J2494-3

- Temperature Range: -58°F to 200°F
- Electrolytic Nickel Plated brass body with a low temperature BUNA-N O-ring
- For use with SAE J844 A & B Nylon tubing
- Compressed air applications
- Thread pre-coated with sealant

GENERAL DATA

Material	Electrolytic Nickel-plated brass OT58 UNI 5705, Tube-support/insert in glass-reinforced Nylon
Collet	Brass OT58, nickel plated
O-ring	Low temperature Buna-N (NBR)
Threads	10/32 UNF, 1/8", 1/4", 3/8", 1/2", 3/4" NPTF
Temperature Range	-58°F - 200°F
Operating pressure	0 - 275 psi (3/4" tube size operating pressure = 0 - 175 psi)
Fluid	Compressed air [for other types of fluid please contact your local Camozzi branch]
Tube diameter	5/32", 1/4", 3/8", 1/2", 5/8", 3/4" OD