

# Nickel-Plated Brass BSPP Nipple Sprint Fittings 2501

Thread Type : BSP (G1/8, G1/4, G3/8, G1/2, G3/4, G1)  
Metric (M5)

BSP THREADS					
DIMENSIONS (in mm)					
Model	A	H	L	SW	Weight (g)
2501 M5	M5	4	11.5	8	2
2501 1/8	G1/8	6	16.5	13	9
2501 1/4	G1/4	8	21	17	15
2501 3/8	G3/8	9	23	19	21
2501 1/2	G1/2	10	25.5	24	35

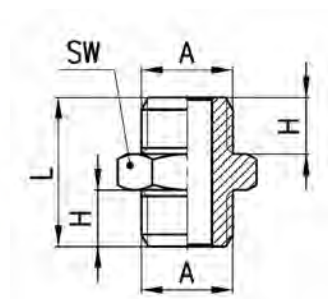

When involved in factory maintenance or plant installation it is often difficult to be absolutely certain which size of fittings will be required. Pipe fittings provide a cost effective solution to this problem. The full range includes straight, L-shaped, T-shaped and cross piece male or female couplings and are available in a variety of thread sizes up to 3/4".

The addition of the Camozzi **Sprint®** seal to twelve different models of pipe fittings eliminates the need to use liquid sealants or tape and save a considerable amount of time during installation. The Sprint® fitting can be connected and disconnected several times.

Material: brass OT58 UNI 5705 (nickel-plated).  
T. min. - 40°C (-40°F)  
T. max. +120°C (250°F)

## GENERAL DATA

Material	nickel-plated brass (UNI 5705 OT58) and PTFE
Threads	10-32 UNF, 1/8", 1/4", 3/8", 1/2" NPTF GAS conical ISO 7 (BSPT), typically models ending in "0" and/or with Sprint "S" prefix GAS cylindrical ISO 228 (BSP), typically models ending with "1", (2651/2661 gaskets required are sold separately)
Pressure	40 bar (0 to 580 psi)
Fluid	Compressed air or other low pressure fluids
Temperature	-40°C - 120°C (-40 F to 250 F)

## Pipe fittings

