

Header Manifolds - 0° Design

Header block mounting hardware is supplied, except for stainless. See page 201 for itemized list.

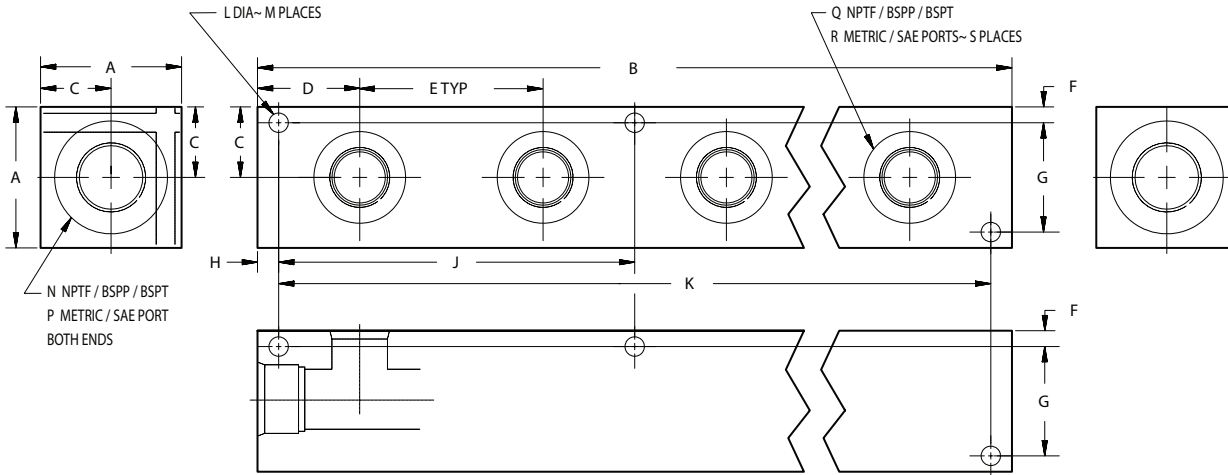

Specifications, descriptions, and dimensional data are subject to correction or change without notice or incurring obligation. Download latest catalog page revisions at www.daman.com.

Ordering Information

Material	Product Type	Side Port Layout	No. of Stations	Side Port Threads
----------	--------------	------------------	-----------------	-------------------

For **coating options** see pages 245-246.

Material	
A	Aluminum - 6061-T6 3000 [†] psi • 20.7 MPa
D	Ductile Iron - D4512 5000 [†] psi • 34.5 MPa
S*	Stainless Steel - 17-4 5000 [†] psi • 34.5 MPa

[†] Working pressure should be considered in accordance with ISO 4413 to determine appropriate material type.

*All stainless steel products are passivated.

Side Port Layout	
000	Ports out one side only

No. of Stations	
01 thru 10	Check chart on next page to verify station-port size combinations

Product Type	
H	Header Block

Side Port Threads					
---	01P	01T	B = BSPP • ISO 1179, BS 2779 P = NPTF • ANSI B1.20.3 T = BSPT • ISO 7, BS 21	04M*	04S*
02B	02P	02T		06M*	06S*
04B*	04P*	04T*		08M*	08S*
06B	06P	06T		12M**	12S**
08B*	08P*	08T*		16M**	16S**
12B**	12P**	12T**		20M**	20S**
16B**	16P**	16T**		24M	24S
20B**	20P**	20T**		Check chart on next page to verify station-port size combinations	
24B	24P	24T			

* Available in Stainless Steel
** Available in Stainless Steel, 1-5 stations
Note: Pipe ports in stainless can gall.

Header Manifolds - 0° Design

PART NO.	A	B	C	D	E	F	G	H	J	K	L	M	N	P	Q	R	S
*H0000101[P,T]	1.25	2.00	0.63	1.00	1.25	0.17	0.91	0.31	--	1.38	0.22	4	1/8	--	1/16	--	1
*H0000201[P,T]		3.25							--	2.63		4					
*H0000301[P,T]		4.50							--	3.88		4					
*H0000401[P,T]		5.75							--	5.13		4					
*H0000501[P,T]		7.00							--	6.38		4					
*H0000601[P,T]		8.25							3.81	7.63		6					
*H0000701[P,T]		9.50							5.06	8.88		6					
*H0000801[P,T]		10.75							5.06	10.13		6					
*H0000901[P,T]		12.00							6.31	11.38		6					
*H0001001[P,T]		13.25							6.31	12.63		6					
*H0000102[B,P,T]	1.50	2.25	0.75	1.13	1.38	0.25	1.00	0.31	--	1.63	0.28	4	1/4	--	1/8	--	1
*H0000202[B,P,T]		3.63							--	3.00		4					
*H0000302[B,P,T]		5.00							--	4.38		4					
*H0000402[B,P,T]		6.38							--	5.75		4					
*H0000502[B,P,T]		7.75							4.25	7.13		6					
*H0000602[B,P,T]		9.13							4.25	8.50		6					
*H0000702[B,P,T]		10.50							5.63	9.88		6					
*H0000802[B,P,T]		11.88							5.63	11.25		6					
*H0000902[B,P,T]		13.25							7.00	12.63		6					
*H0001002[B,P,T]		14.63							7.00	14.00		6					
H0000104	1.75	2.13	0.88	1.06	1.75	0.25	1.25	0.31	--	1.50	0.28	4	3/8	-6 or M14x1.5	1/4	-4 or M10x1.0	1
H0000204		3.88							--	3.25		4					
H0000304		5.63							--	5.00		4					
H0000404		7.38							--	6.75		4					
H0000504		9.13							5.13	8.50		6					
H0000604		10.88							5.13	10.25		6					
H0000704		12.63							6.88	12.00		6					
H0000804		14.38							6.88	13.75		6					
H0000904		16.13							8.63	15.50		6					
H0001004		17.88							8.63	17.25		6					
*H0000106[B,P,T]	2.00	3.00	1.00	1.50	2.00	0.25	1.50	0.31	--	2.38	0.28	4	1/2	--	3/8	--	1
*H0000206[B,P,T]		5.00							--	4.38		4					
*H0000306[B,P,T]		7.00							--	6.38		4					
*H0000406[B,P,T]		9.00							--	8.38		4					
*H0000506[B,P,T]		11.00							6.19	10.38		6					
*H0000606[B,P,T]		13.00							6.19	12.38		6					
*H0000706[B,P,T]		15.00							8.19	14.38		6					
*H0000806[B,P,T]		17.00							8.19	16.38		6					
*H0000906[B,P,T]		19.00							10.19	18.38		6					
*H0001006[B,P,T]		21.00							10.19	20.38		6					
*H0000106[M,S]	1.75	3.00	0.88	1.50	2.00	0.25	1.25	0.31	--	2.38	0.28	4	--	-8 or M18x1.5	--	-6 or M14x1.5	1
*H0000206[M,S]		5.00							--	4.38		4					
*H0000306[M,S]		7.00							--	6.38		4					
*H0000406[M,S]		9.00							--	8.38		4					
*H0000506[M,S]		11.00							6.19	10.38		6					
*H0000606[M,S]		13.00							6.19	12.38		6					
*H0000706[M,S]		15.00							8.19	14.38		6					
*H0000806[M,S]		17.00							8.19	16.38		6					
*H0000906[M,S]		19.00							10.19	18.38		6					
*H0001006[M,S]		21.00							10.19	20.38		6					
*H0000108[B,P,T]	2.00	3.00	1.00	1.50	2.38	0.25	1.50	0.31	--	2.38	0.28	4	3/4	--	1/2	--	1
*H0000208[B,P,T]		5.38							--	4.75		4					
*H0000308[B,P,T]		7.75							--	7.13		4					
*H0000408[B,P,T]		10.13							--	9.50		4					
*H0000508[B,P,T]		12.50							7.13	11.88		6					
*H0000608[B,P,T]		14.88							7.13	14.25		6					
*H0000708[B,P,T]		17.25							9.50	16.63		6					
*H0000808[B,P,T]		19.63							9.50	19.00		6					
*H0000908[B,P,T]		22.00							11.88	21.38		6					
*H0001008[B,P,T]		24.38							11.88	23.75		6					

Chart continued on next page

Custom Products
 Standard Manifolds
 Cover Plates
 Valve Adaptors
 Subplates
 Servo Valve Subplates
 Tapping Plates
 Cartridge Valve Cavity Bodies
 Header and Junction Blocks
 Technical Information

Header Manifolds - 0° Design (cont)

PART NO.	A	B	C	D	E	F	G	H	J	K	L	M	N	P	Q	R	S
*H0000108[M,S]		3.00							--	2.38		4					1
*H0000208[M,S]		5.38							--	4.75		4					2
*H0000308[M,S]		7.75							--	7.13		4					3
*H0000408[M,S]		10.13							--	9.50		4					4
*H0000508[M,S]	2.25	12.50	1.13	1.50	2.38	0.25	1.75	0.31	7.13	11.88	0.28	6	--	-12 or M27x2.0	--	-8 or M18x1.5	5
*H0000608[M,S]		14.88							7.13	14.25		6					6
*H0000708[M,S]		17.25							9.50	16.63		6					7
*H0000808[M,S]		19.63							9.50	19.00		6					8
*H0000908[M,S]		22.00							11.88	21.38		6					9
*H0001008[M,S]		24.38							11.88	23.75		6					10
H0000112		3.63							--	2.88		4					1
H0000212		6.88							--	6.13		4					2
H0000312		10.13							--	9.38		4					3
H0000412		13.38							--	12.63		4					4
H0000512	2.50	16.63	1.25	1.81	3.25	0.28	1.94	0.38	9.56	15.88	0.34	6	1"	-16 or M33x2.0	3/4	-12 or M27x2.0	5
H0000612		19.88							9.56	19.13		6					6
H0000712		23.13							12.81	22.38		6					7
H0000812		26.38							12.81	25.63		6					8
H0000912		29.63							16.06	28.88		6					9
H0001012		32.88							16.06	32.13		6					10
H0000116		4.00							--	3.25		4					1
H0000216		7.75							--	7.00		4					2
H0000316		11.50							--	10.75		4					3
H0000416		15.25							--	14.50		4					4
H0000516	3.00	19.00	1.50	2.00	3.75	0.34	2.31	0.38	11.00	18.25		6	1-1/4	-20 or M42x2.0	1"	-16 or M33x2.0	5
H0000616		22.75							11.00	22.00		6					6
H0000716		26.50							14.75	25.75		6					7
H0000816		30.25							14.75	29.50		6					8
H0000916		34.00							18.50	33.25		6					9
H0001016		37.75							18.50	37.00		6					10
H0000120		4.50							--	3.50		4					1
H0000220		8.50							--	7.50		4					2
H0000320		12.50							--	11.50		4					3
H0000420		16.50							--	15.50		4					4
H0000520	3.50	20.50	1.75	2.25	4.00	0.41	2.69	0.50	11.75	19.50	0.53	6	1-1/2	-24 or M48x2.0	1-1/4	-20 or M42x2.0	5
H0000620		24.50							11.75	23.50		6					6
H0000720		28.50							15.75	27.50		6					7
H0000820		32.50							15.75	31.50		6					8
H0000920		36.50							19.75	35.50		6					9
H0001020		40.50							19.75	39.50		6					10
*H0000124[B,P,T]		5.00							--	4.00		4					1
*H0000224[B,P,T]		10.00							--	9.00		4					2
*H0000324[B,P,T]		15.00							--	14.00		4					3
*H0000424[B,P,T]		20.00							9.50	19.00		6					4
*H0000524[B,P,T]	4.00	25.00	2.00	2.50	5.00	0.41	3.19	0.50	14.50	24.00	0.53	6	2"	--	1-1/2	--	5
*H0000624[B,P,T]		30.00							14.50	29.00		6					6
*H0000724[B,P,T]		35.00							19.50	34.00		6					7
*H0000824[B,P,T]		40.00							19.50	39.00		6					8
*H0000924[B,P,T]		45.00							24.50	44.00		6					9
*H0001024[B,P,T]		50.00							24.50	49.00		6					10
*H0000124[M,S]		5.00							--	4.00		4					1
*H0000224[M,S]		10.00							--	9.00		4					2
*H0000324[M,S]		15.00							--	14.00		4					3
*H0000424[M,S]		20.00							9.50	19.00		6					4
*H0000524[M,S]	4.50	25.00	2.25	2.50	5.00	0.41	3.69	0.50	14.50	24.00	0.53	6	--	-32 or M60x2.0	--	-24 or M48x2.0	5
*H0000624[M,S]		30.00							14.50	29.00		6					6
*H0000724[M,S]		35.00							19.50	34.00		6					7
*H0000824[M,S]		40.00							19.50	39.00		6					8
*H0000924[M,S]		45.00							24.50	44.00		6					9
*H0001024[M,S]		50.00							24.50	49.00		6					10