

# Junction Manifolds - 270° Design

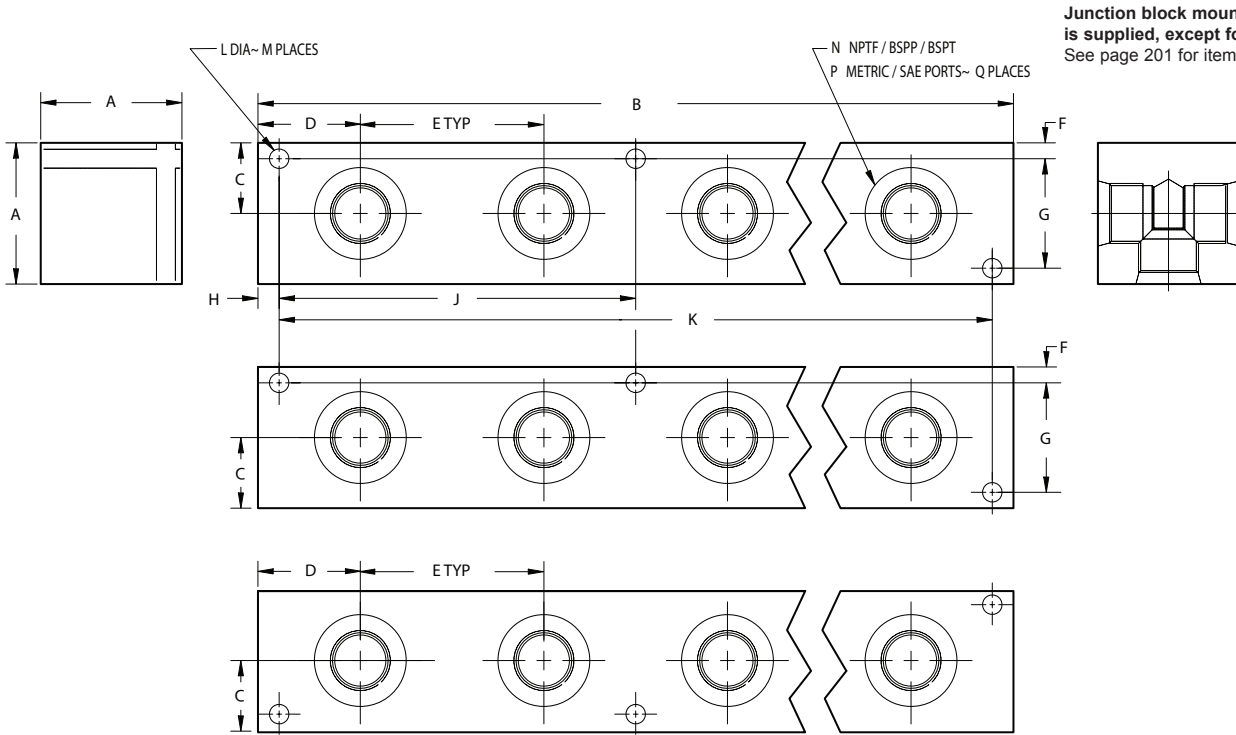

Junction block mounting hardware is supplied, except for stainless. See page 201 for itemized list.

Specifications, descriptions, and dimensional data are subject to correction or change without notice or incurring obligation. Download latest catalog page revisions at [www.daman.com](http://www.daman.com).

## Ordering Information

Material	Product Type	Side Port Layout	No. of Stations	Side Port Threads																																																																								
<table border="1" style="width: 100%; border-collapse: collapse;"> <thead> <tr> <th colspan="2">Material</th> </tr> </thead> <tbody> <tr> <td style="text-align: center;"><b>A</b></td> <td>Aluminum - 6061-T6 3000† psi • 20.7 MPa</td> </tr> <tr> <td style="text-align: center;"><b>D</b></td> <td>Ductile Iron - D4512 5000† psi • 34.5 MPa</td> </tr> <tr> <td style="text-align: center;"><b>S*</b></td> <td>Stainless Steel - 17-4 5000† psi • 34.5 MPa</td> </tr> <tr> <td colspan="2">† Working pressure should be considered in accordance with ISO 4413 to determine appropriate material type.</td> </tr> <tr> <td colspan="2">*All stainless steel products are passivated.</td> </tr> </tbody> </table>	Material		<b>A</b>	Aluminum - 6061-T6 3000† psi • 20.7 MPa	<b>D</b>	Ductile Iron - D4512 5000† psi • 34.5 MPa	<b>S*</b>	Stainless Steel - 17-4 5000† psi • 34.5 MPa	† Working pressure should be considered in accordance with ISO 4413 to determine appropriate material type.		*All stainless steel products are passivated.		<table border="1" style="width: 100%; border-collapse: collapse;"> <thead> <tr> <th colspan="2">Product Type</th> </tr> </thead> <tbody> <tr> <td style="text-align: center;"><b>J</b></td> <td>Junction Block</td> </tr> </tbody> </table>	Product Type		<b>J</b>	Junction Block	<table border="1" style="width: 100%; border-collapse: collapse;"> <thead> <tr> <th colspan="2">Side Port Layout</th> </tr> </thead> <tbody> <tr> <td style="text-align: center;"><b>270</b></td> <td>Ports out three adjacent sides</td> </tr> </tbody> </table>	Side Port Layout		<b>270</b>	Ports out three adjacent sides	<table border="1" style="width: 100%; border-collapse: collapse;"> <thead> <tr> <th colspan="2">No. of Stations</th> </tr> </thead> <tbody> <tr> <td style="text-align: center;">01 thru 10</td> <td>Check chart on next page to verify station-port size combinations</td> </tr> </tbody> </table>	No. of Stations		01 thru 10	Check chart on next page to verify station-port size combinations	<table border="1" style="width: 100%; border-collapse: collapse;"> <thead> <tr> <th colspan="6">Side Port Threads</th> </tr> </thead> <tbody> <tr> <td style="text-align: center;"><b>04B*</b></td> <td style="text-align: center;"><b>04P*</b></td> <td style="text-align: center;"><b>04T*</b></td> <td style="text-align: center;"><b>04M*</b></td> <td style="text-align: center;"><b>04S*</b></td> <td rowspan="8" style="text-align: center; vertical-align: middle;"> <small>M = METRIC • ISO 6149 S = SAE • ISO 11926, SAE 1926</small> </td> </tr> <tr> <td style="text-align: center;"><b>06B*</b></td> <td style="text-align: center;"><b>06P*</b></td> <td style="text-align: center;"><b>06T*</b></td> <td style="text-align: center;"><b>06M*</b></td> <td style="text-align: center;"><b>06S*</b></td> </tr> <tr> <td style="text-align: center;"><b>08B</b></td> <td style="text-align: center;"><b>08P</b></td> <td style="text-align: center;"><b>08T</b></td> <td style="text-align: center;"><b>08M</b></td> <td style="text-align: center;"><b>08S</b></td> </tr> <tr> <td style="text-align: center;"><b>12B*</b></td> <td style="text-align: center;"><b>12P*</b></td> <td style="text-align: center;"><b>12T*</b></td> <td style="text-align: center;"><b>12M*</b></td> <td style="text-align: center;"><b>12S*</b></td> </tr> <tr> <td style="text-align: center;"><b>16B*</b></td> <td style="text-align: center;"><b>16P*</b></td> <td style="text-align: center;"><b>16T*</b></td> <td style="text-align: center;"><b>16M*</b></td> <td style="text-align: center;"><b>16S*</b></td> </tr> <tr> <td style="text-align: center;"><b>20B*</b></td> <td style="text-align: center;"><b>20P*</b></td> <td style="text-align: center;"><b>20T*</b></td> <td style="text-align: center;"><b>20M*</b></td> <td style="text-align: center;"><b>20S*</b></td> </tr> <tr> <td style="text-align: center;"><b>24B</b></td> <td style="text-align: center;"><b>24P</b></td> <td style="text-align: center;"><b>24T</b></td> <td style="text-align: center;"><b>24M</b></td> <td style="text-align: center;"><b>24S</b></td> </tr> <tr> <td colspan="5" style="text-align: center;">Check chart on next page to verify station-port size combinations</td> </tr> </tbody> </table>	Side Port Threads						<b>04B*</b>	<b>04P*</b>	<b>04T*</b>	<b>04M*</b>	<b>04S*</b>	<small>M = METRIC • ISO 6149 S = SAE • ISO 11926, SAE 1926</small>	<b>06B*</b>	<b>06P*</b>	<b>06T*</b>	<b>06M*</b>	<b>06S*</b>	<b>08B</b>	<b>08P</b>	<b>08T</b>	<b>08M</b>	<b>08S</b>	<b>12B*</b>	<b>12P*</b>	<b>12T*</b>	<b>12M*</b>	<b>12S*</b>	<b>16B*</b>	<b>16P*</b>	<b>16T*</b>	<b>16M*</b>	<b>16S*</b>	<b>20B*</b>	<b>20P*</b>	<b>20T*</b>	<b>20M*</b>	<b>20S*</b>	<b>24B</b>	<b>24P</b>	<b>24T</b>	<b>24M</b>	<b>24S</b>	Check chart on next page to verify station-port size combinations					<p>For <b>coating options</b> see pages 245-246.</p>
Material																																																																												
<b>A</b>	Aluminum - 6061-T6 3000† psi • 20.7 MPa																																																																											
<b>D</b>	Ductile Iron - D4512 5000† psi • 34.5 MPa																																																																											
<b>S*</b>	Stainless Steel - 17-4 5000† psi • 34.5 MPa																																																																											
† Working pressure should be considered in accordance with ISO 4413 to determine appropriate material type.																																																																												
*All stainless steel products are passivated.																																																																												
Product Type																																																																												
<b>J</b>	Junction Block																																																																											
Side Port Layout																																																																												
<b>270</b>	Ports out three adjacent sides																																																																											
No. of Stations																																																																												
01 thru 10	Check chart on next page to verify station-port size combinations																																																																											
Side Port Threads																																																																												
<b>04B*</b>	<b>04P*</b>	<b>04T*</b>	<b>04M*</b>	<b>04S*</b>	<small>M = METRIC • ISO 6149 S = SAE • ISO 11926, SAE 1926</small>																																																																							
<b>06B*</b>	<b>06P*</b>	<b>06T*</b>	<b>06M*</b>	<b>06S*</b>																																																																								
<b>08B</b>	<b>08P</b>	<b>08T</b>	<b>08M</b>	<b>08S</b>																																																																								
<b>12B*</b>	<b>12P*</b>	<b>12T*</b>	<b>12M*</b>	<b>12S*</b>																																																																								
<b>16B*</b>	<b>16P*</b>	<b>16T*</b>	<b>16M*</b>	<b>16S*</b>																																																																								
<b>20B*</b>	<b>20P*</b>	<b>20T*</b>	<b>20M*</b>	<b>20S*</b>																																																																								
<b>24B</b>	<b>24P</b>	<b>24T</b>	<b>24M</b>	<b>24S</b>																																																																								
Check chart on next page to verify station-port size combinations																																																																												

\* Available in Stainless Steel  
Note: Pipe ports in stainless can gall.

# Junction Manifolds - 270° Design

PART NO.	A	B	C	D	E	F	G	H	J	K	L	M	N	P	Q
*J2700104*		2.13							--	1.50		4			3
*J2700204*		3.88							--	3.25		4			6
*J2700304*		5.63							--	5.00		4			9
*J2700404*		7.38							--	6.75		4			12
*J2700504*	1.75	9.13	0.88	1.06	1.75	0.25	1.25	0.31	5.13	8.50	0.28	6	1/4	-4 or M10x1.0	15
*J2700604*		10.88							5.13	10.25		6			18
*J2700704*		12.63							6.88	12.00		6			21
*J2700804*		14.38							6.88	13.75		6			24
*J2700904*		16.13							8.63	15.50		6			27
*J2701004*		17.88							8.63	17.25		6			30
*J2700106*		3.00							--	2.38		4			3
*J2700206*		5.00							--	4.38		4			6
*J2700306*		7.00							--	6.38		4			9
*J2700406*		9.00							--	8.38		4			12
*J2700506*	1.75	11.00	0.88	1.50	2.00	0.25	1.25	0.31	6.19	10.38	0.28	6	3/8	-6 or M14x1.5	15
*J2700606*		13.00							6.19	12.38		6			18
*J2700706*		15.00							8.19	14.38		6			21
*J2700806*		17.00							8.19	16.38		6			24
*J2700906*		19.00							10.19	18.38		6			27
*J2701006*		21.00							10.19	20.38		6			30
*J2700108*		3.00							--	2.38		4			3
*J2700208*		5.38							--	4.75		4			6
*J2700308*		7.75							--	7.13		4			9
*J2700408*		10.13							--	9.50		4			12
*J2700508*	2.00	12.50	1.00	1.50	2.38	0.25	1.50	0.31	7.13	11.88	0.28	6	1/2	-8 or M18x1.5	15
*J2700608*		14.88							7.13	14.25		6			18
*J2700708*		17.25							9.50	16.63		6			21
*J2700808*		19.63							9.50	19.00		6			24
*J2700908*		22.00							11.88	21.38		6			27
*J2701008*		24.38							11.88	23.75		6			30
*J2700112*		3.63							--	2.88		4			3
*J2700212*		6.88							--	6.13		4			6
*J2700312*		10.13							--	9.38		4			9
*J2700412*		13.38							--	12.63		4			12
*J2700512*	2.50	16.63	1.25	1.81	3.25	0.28	1.94	0.38	9.56	15.88	0.34	6	3/4	-12 or M27x2.0	15
*J2700612*		19.88							9.56	19.13		6			18
*J2700712*		23.13							12.81	22.38		6			21
*J2700812*		26.38							12.81	25.63		6			24
*J2700912*		29.63							16.06	28.88		6			27
*J2701012*		32.88							16.06	32.13		6			30
*J2700116*		4.00							--	3.25		4			3
*J2700216*		7.75							--	7.00		4			6
*J2700316*		11.50							--	10.75		4			9
*J2700416*		15.25							--	14.50		4			12
*J2700516*	3.00	19.00	1.50	2.00	3.75	0.34	2.31	0.38	11.00	18.25	B.M., T ports = 0.41	6	1"	-16 or M33x2.0	15
*J2700616*		22.75							11.00	22.00		6			18
*J2700716*		26.50							14.75	25.75		6			21
*J2700816*		30.25							14.75	29.50		6			24
*J2700916*		34.00							18.50	33.25		6			27
*J2701016*		37.75							18.50	37.00		6			30
*J2700120*		4.50							--	3.50		4			3
*J2700220*		8.50							--	7.50		4			6
*J2700320*		12.50							--	11.50		4			9
*J2700420*		16.50							--	15.50		4			12
*J2700520*	3.50	20.50	1.75	2.25	4.00	0.41	2.69	0.50	11.75	19.50	0.53	6	1-1/4	-20 or M42x2.0	15
*J2700620*		24.50							11.75	23.50		6			18
*J2700720*		28.50							15.75	27.50		6			21
*J2700820*		32.50							15.75	31.50		6			24
*J2700920*		36.50							19.75	35.50		6			27
*J2701020*		40.50							19.75	39.50		6			30

Chart continued on next page

Custom Products  
 Standard Manifolds  
 Cover Plates  
 Valve Adaptors  
 Subplates  
 Servo Valve Subplates  
 Tapping Plates  
 Cartridge Valve Cavity Bodies  
 Header and Junction Blocks  
 Technical Information

# Junction Manifolds - 270° Design (cont)

PART NO.	A	B	C	D	E	F	G	H	J	K	L	M	N	P	Q
*J2700124*		5.00							--	4.00		4			3
*J2700224*		10.00							--	9.00		4			6
*J2700324*		15.00							--	14.00		4			9
*J2700424*		20.00							9.50	19.00		6			12
*J2700524*	4.00	25.00	2.00	2.50	5.00	0.41	3.19	0.50	14.50	24.00	0.53	6	1-1/2	-24	15
*J2700624*		30.00							14.50	29.00		6		or	18
*J2700724*		35.00							19.50	34.00		6		M48x2.0	21
*J2700824*		40.00							19.50	39.00		6			24
*J2700924*		45.00							24.50	44.00		6			27
*J2701024*		50.00							24.50	49.00		6			30