

RETURN LINE DIFFUSERS

Return Line Diffusers are an economical and highly effective way to reduce aeration, foaming, turbulence and noise caused by return lines. Baffles can usually be eliminated, provided that the holes in the diffuser are positioned away from the pump suction inlet and below the oil level.

Standard Features:

- Max working pressure 290 PSI (20 bar)
- Working temperature -13° to 230°F (-25° to 110°C)

Standard Materials:

- Zinc plated steel

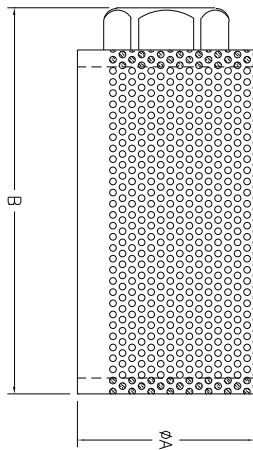
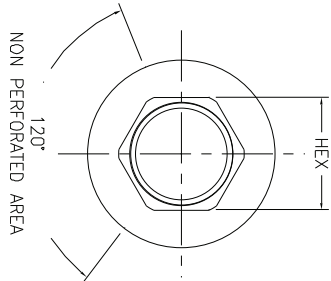

RLD Series									
Part No.	Pipe Size NPT (inch)	Return Flow @ 20 ft/second		Dimensions					
		GPM	L/min	A		B		Hex	
				in	mm	in	mm	in	mm
RLD30	3/4	33	125	3.40	86	3.00	76	1.31	33
RLD50	1	53	201	3.40	86	4.20	107	1.62	41
RLD90	1 1/4	93	342	3.40	86	6.50	165	1.88	48
RLD120	1 1/2	126	479	4.50	114	6.60	168	2.12	54
RLD200	2	209	794	4.50	114	10.30	262	2.75	70
RLD290*	2 1/2	298	1128	5.20	132	9.13	232	N/A	N/A
RLD450*	3	460	1748	5.20	132	10.00	254	N/A	N/A

*uses round half coupling versus hex stock

Dimensions and specifications are subject to change without notice. Not all items are Made-To-Stock, contact us for availability.

10/14

Ph : 920-682-6877
Fx : 920-684-7210



sales@ldi-industries.com
www.ldi-industries.com