

# Brackets

## Miniature Mounting Brackets

BR1611 Bracket & Ring  
PK1611 Ring Only

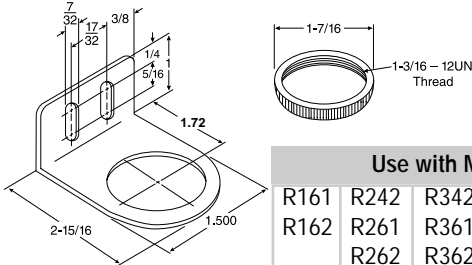

Use with Model #				
R161	R242	R342	7681	741
R162	R261	R361	7682	742
	R262	R362	7621	7622

## FBK5

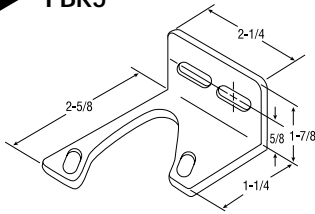

Use with Model #		
F352	L352	L452
F353	L353	L453
F354	L354	L454

## RBK5

Mounting bracket for Tri-Star, Midflow, and precision regulators listed below. Also can be used for Tri-Star FRL Combination units.

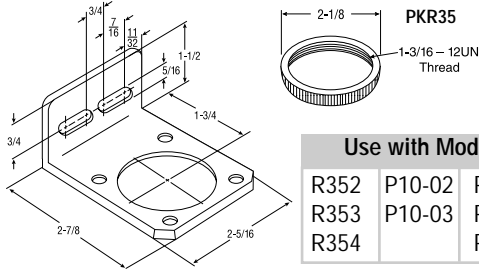

Use with Model #		
R352	P10-02	P14-02
R353	P10-03	P14-03
R354		P14-04

## ABK-10

Use with Model #

VC7510  
VC7510XL  
VC7525

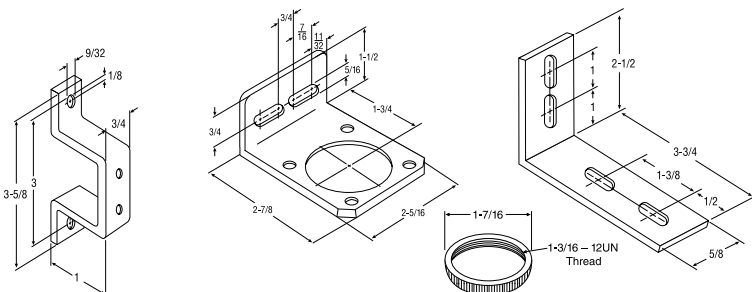

## BR5702 Bracket

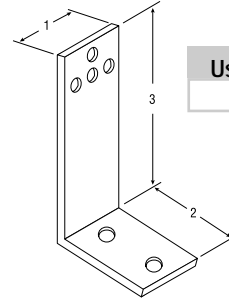

Use with Model #  
5702S

## FBK7 Midflow Brackets

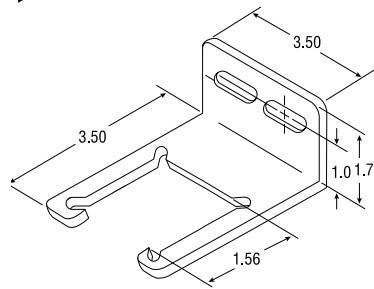

Use with Model #			
F373	F383	L373	L383
F374	F384	L374	L384
F376	F386	L376	L386

## ACA Pipe Brackets

Mounting bracket for use with Tri-Star FRL's.  
Example: N33354

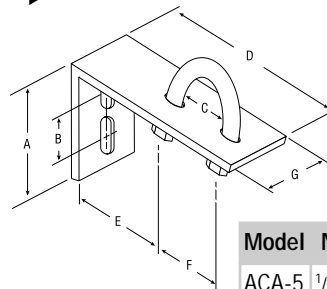

Model	NPT	A	B	C	D	E	F	G
ACA-5	1/4", 3/8"	2 1/2"	3/16"	3/4"	3 7/8"	2 1/16"	1 5/16"	5/8"
ACA-6	1/2", 3/4"	2 1/2"	3/16"	1 5/32"	3 7/8"	1 13/16"	1 5/16"	5/8"
ACA-7	1"	2 1/2"	3/16"	1 1/2"	3 7/8"	1 5/8"	1 11/16"	5/8"

## FBK3 Bracket

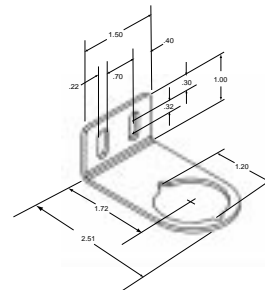

Use with Model #	
F300-01	L181
F300-02	L182
F500-01	
F500-02	

## RBK7 Bracket

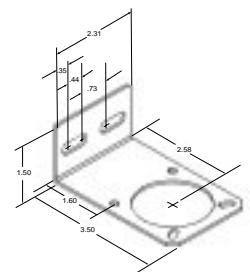

Use with Model #	
R373	R374
R376	R378