

Filters Series MX

Ports 3/8" - 1" NPTF

MX2 ports: 3/8", 1/2", 3/4" NPTF - MX3 ports: 3/4" 1" NPTF

Innovative modular clamping system

Quick-Release, locking bayonet bowls

Series MX3 is the latest air treatment system offered by Camozzi. This modular design is characterized by a modern, compact design, and high performance. The integration between metal alloys and technopolymers has allowed the realization of a reliable product, both light and strong at the same time. The unique and patented modular clamping system simplifies the mounting of components.

The Series MX appeals to a broad spectrum of markets and applications because of the savings realized in installation time, space requirements and total cost.

A special configurator, available on Camozzi's global website at <http://catalogue.camozzi.com> (sec. Configurators), allows the customer to choose the most suitable solution for his application, selecting single components or by configuring assembled FRLs.



- » Removal of impurities and condensate
- » High flow with minimal pressure decreases
- » Cartridge filters of 25 or 5 μ m
- » Manual, automatic, depressurizing and ported condensate drain
- » Bowl locking mechanism reduces the risk of accidents

GENERAL DATA

Construction	modular, compact with filtering element in HDPE
Materials	see TABLE OF MATERIALS
Ports	3/8" - 1" NPTF
Condensate capacity	MX3: 85 cc, (approx. 3 oz.), MX2: 55 cc (approx. 1.9 oz.)
Mounting	vertical in-line wall-mounting (by means of clamps)
Operating temperature	-5°C - 50°C at 16 bar with Dew Point of air at least 2° C (4° F) below the min working temperature, (23 F - 122 F @ 232 psi, up to 140 F MAX at 145 psi) -5°C - 60°C at 10 bar with Dew Point of air at least 2° C (4° F) below the min working temperature
Porosity of filtering element	25 μ m 5 μ m
Draining of condensate	manual, automatic, depressurizing and ported
Operating pressure	0,3 - 16 bar (with automatic drain 1,5 - 12 bar, (4,5 - 232 psi, 22 - 175 psi w/ automatic drain option))
Nominal flow	see FLOW DIAGRAMS
Fluid	compressed air

CODING EXAMPLE

MX	2	-	3/8	-	F	0	0	TF
MX	SERIES							
2	SIZE: 2 = 3/8" - 1/2" - 3/4" 3 = 3/4" - 1"							
3/8	PORTS: 3/8 = 3/8 1/2 = 1/2 3/4 = 3/4 1 = 1							
F	FILTER							
0	FILTERING ELEMENT: 0 = 25 µm (standard) 1 = 5 µm							
0	DRAINING OF CONDENSATE: 0 = semiautomatic-manual drain (standard) 3 = automatic drain 5 = depressuring drain, filtered orifice 8 = without drain, with port G1/8							
TF	TF = NPTF ports blank = BSP ports							

For the assembly of a single component with fixing flanges or wall-mounting, see the section "FRL Series MX Assembled"

Filters Series MX - materials

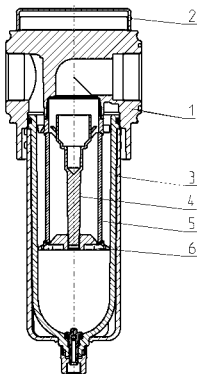

PARTS	MATERIALS
1 = Body	Aluminium
2 = Covering	Polyacetal
3 = Bowl with technopolymer cover	Polycarbonate/Polyamide
4 = Valve-guide	Polyacetal
5 = Filtering element	Polyethylene
6 = Separation deflector	Polyacetal
Seals	NBR

MX3 FLOW DIAGRAMS

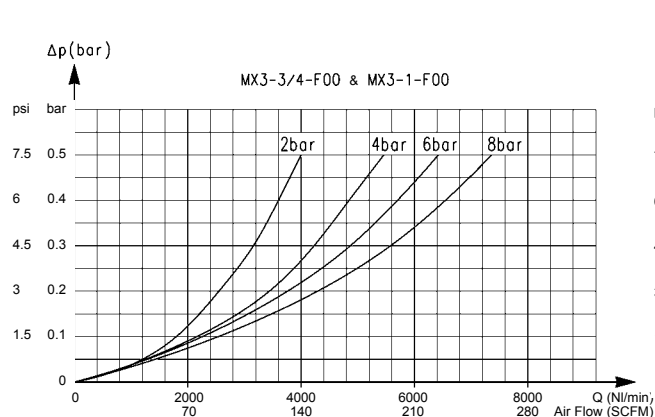

Reference diagram for models with filtering element = 25 µm

ΔP = Pressure drop
 Q = Flow

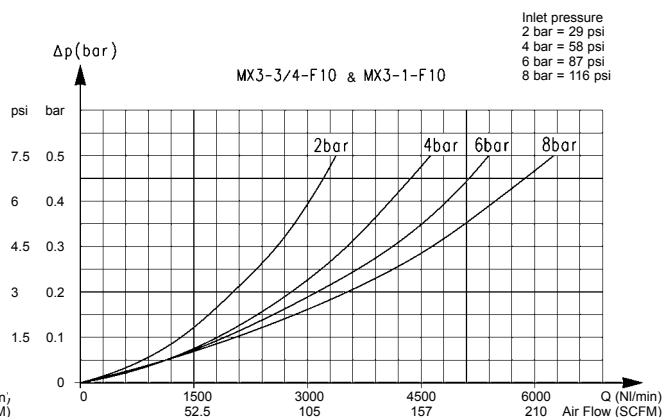

Reference diagram for models with filtering element = 5 µm

ΔP = Pressure drop
 Q = Flow

MX2 FLOW DIAGRAMS

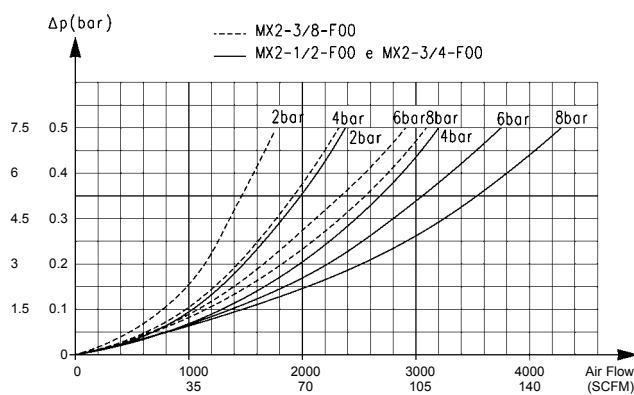

Reference diagram for models with filtering element = 25 µm

Δp = Pressure drop
 Q = Flow

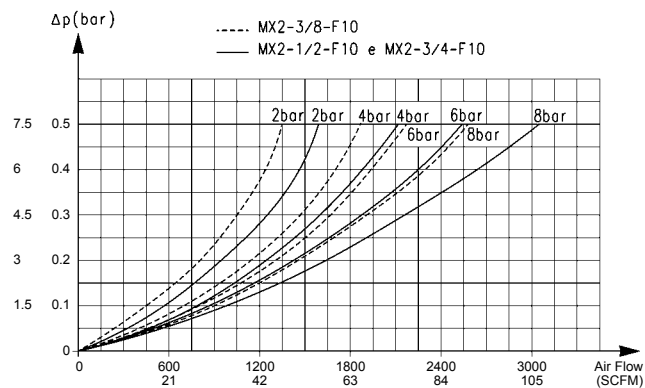

Reference diagram for models with filtering element = 5 µm

Δp = Pressure drop
 Q = Flow

Filters Series MX - dimensions

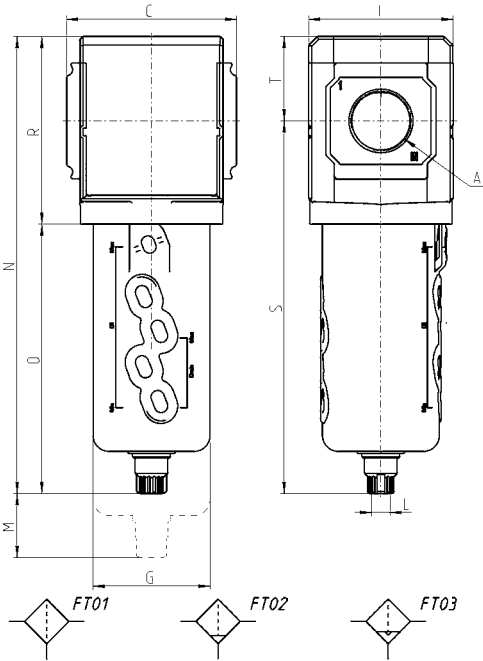

FT01 = filter without drain with threaded port

FT02 = filter with semiautomatic manual drain

FT03 = filter with automatic or depressuring drain

DIMENSIONS (in inches)												
Mod.	A	C	G	I	L	M	N	O	R	S	T	Weight (kg)
MX2-3/8-F00TF	3/8	2.756	2.177	2.677	1/8	2.264	8.346	5.000	3.346	6.870	1.476	0.5
MX2-1/2-F00TF	1/2	2.756	2.177	2.677	1/8	2.264	8.346	5.000	3.346	6.870	1.476	0.5
MX2-3/4-F00TF	3/4	2.756	2.177	2.677	1/8	2.264	8.346	5.000	3.346	6.870	1.476	0.5
MX3-3/4-F00TF	3/4	3.524	2.421	2.992	1/8	2.953	9.488	5.591	3.898	7.736	1.752	0.8
MX3-1-F00TF	1	3.524	2.421	2.992	1/8	2.953	9.488	5.591	3.898	7.736	1.752	0.7

MODULAR FRL SERIES MX